

Notes:
 1. Data from the most recent 2010 sampling event used except where noted.
 2. For co-located wells completed at multiple depths, the highest value for the period was mapped.
 3. Isoconcentration lines are dashed where inferred for 2010 data.

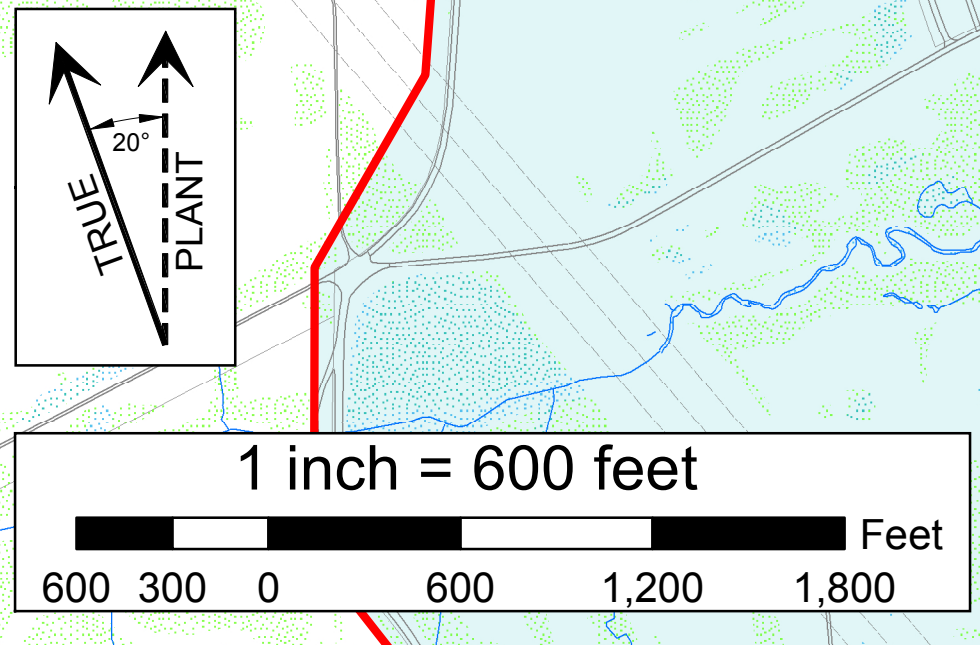

LEGEND

- 2010 Plume Concentration Fields
- TCE ≥ 5 µg/L
- TCE ≥ 100 µg/L
- TCE ≥ 1,000 µg/L
- TCE ≥ 10,000 µg/L
- TCE ≥ 100,000 µg/L
- Water Policy Area
- Source Areas
- Parcel Lines
- Monitoring Well Identification, Date of Sample, and Sample Value
- Residential Well (1)
- RGA Well (193)
- Extraction Well (4)
- Inactive Extraction Well (4)
- DOE Property Boundary
- Roadways
- Streams
- Railroad
- TVA Powerlines

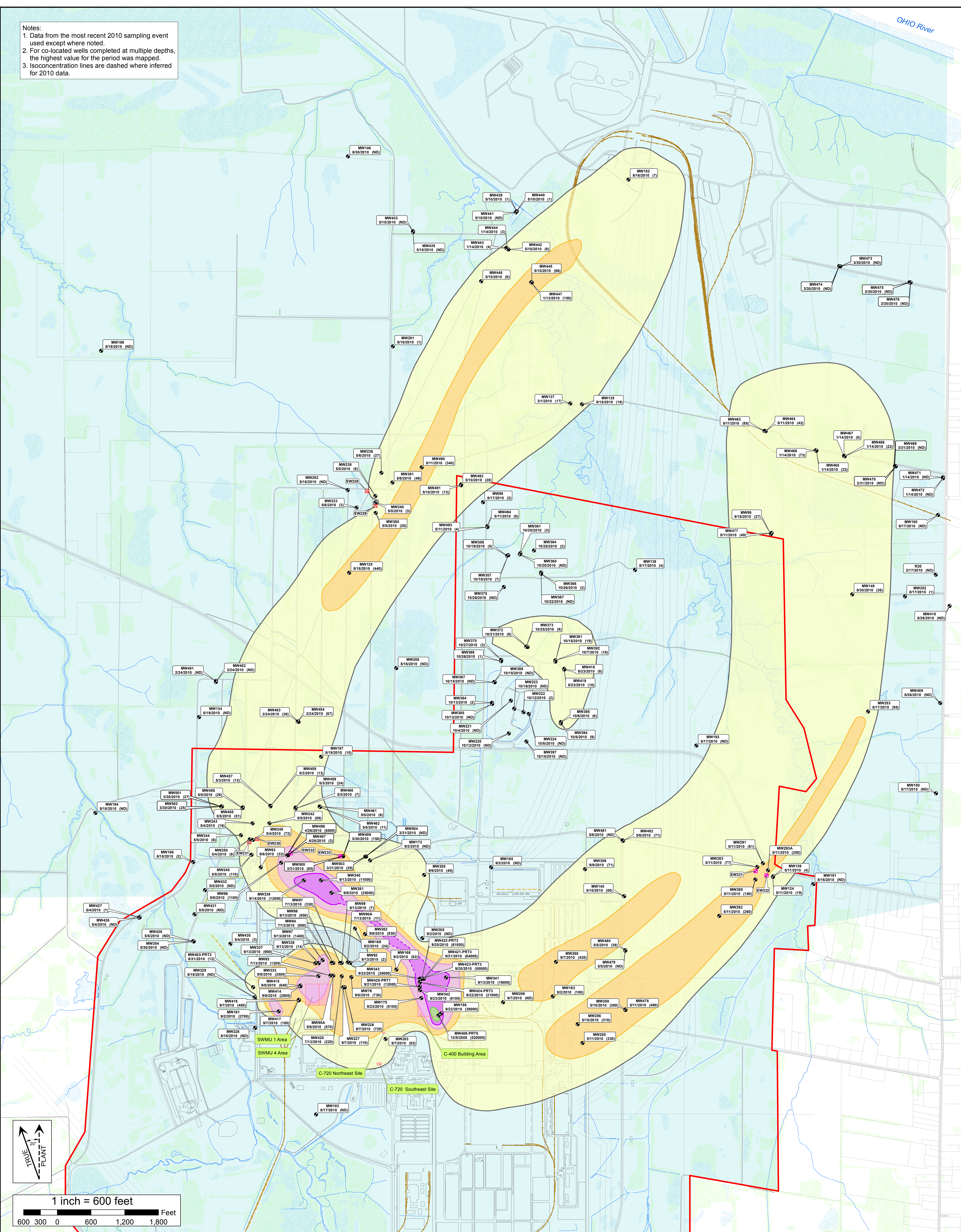

U.S. DEPARTMENT OF ENERGY
 PORTSMOUTH / PADUCAH PROJECT OFFICE
 PADUCAH GASEOUS DIFFUSION PLANT

Figure C.2. 2010 TCE Plume—Regional Gravel Aquifer

FILE NAME: Fig_C02_2010_TCE_PLUME_r1	PROJECT #: EM	SCALE: AS NOTED	DATE: 08-29-2011
---	------------------	--------------------	---------------------